



LUCKY 13 Printable Jointed Figure



soozafone

[VIEW IN BROWSER](#)

updated 26. 8. 2023 | published 26. 8. 2023

Summary

Lucky 13 is a fully 3D printable, highly poseable, snap-together, modular, customizable, jointed figure.



10.98 hrs



1 pcs



0.15 mm



0.40 mm



PET



64 g



Prusa
MK3/S/S+

[Toys & Games](#) > [Action Figures & Statues](#)

Tags: [toy](#) [display](#) [modular](#) [figure](#) [articulated](#)
[customizable](#) [snapfit](#) [poseable](#) [actionfigure](#) [balljoint](#)
[jointed](#)

Want to sell prints of Lucky 13? Join my Printables Club!

\$15 a month lets you sell unlimited physical prints. Click “Support and Join” above and grab the Seller License! Want to say thanks with a one-time donation? [Make a PayPal donation here!](#)

Psst... Maybe you'd also be interested in [Easy 13?](#) The same looks as Lucky 13, but easier to print and assemble!

--

Lucky 13 is a fully 3D printable, highly poseable, snap-together, modular, customizable, jointed figure. This starter set features everything you need to start printing, playing, and making it your own. The included STL files give you access to:

- A core armature with lifelike articulation!
- A basic skin that easily snap-fits for customization!
- A set of accessories for extra inspiration!
- A display base to show off your figure in extra-dynamic poses!

Make sure you grab the PDF manual from the files! I hope you'll have as much fun with Lucky 13 as I have!

Print details:

- Material: **PETG**
- Layer height: **0.15mm**
- Supports: **no**
- Infill: **15%**

All sample images are printed on a Prusa MK3S and/or Prusa MINI.

Note 1: Some file names were changed slightly in the upload, but you should still be able to follow the manual. When I say "armature parts," I mean parts that say "armature" in their filename, and so on.

Note 2: I've added one pre-sliced gcode file to be able to display print time estimates. **However, I strongly recommend that you your own slicing.** You're not allowed to get mad at me if you just stick that file on an SD card and it doesn't work perfectly.

Note 3: The "A16" parts are only needed if you want to assemble just the armature without the skin, like in the first picture. They attach to the foot joints. The next release will have that called out in the manual.

If you like this print, consider sending me a tip to support developing the next version :)







Change log:

10 Mar 2022: Fixed some manifold errors, updated file organization for better clarity.

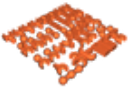
11 Mar 2022: Uploaded new versions of parts 00A08 and 00A11 with added chamfer for ease of assembly. Uploaded new versions of parts 00B08L/R, 00B12, 00B13, 00B15, 00B16 with increased tolerances. Updated plated part files to match new individual part versions.

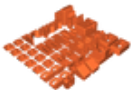
1 Apr 2022: Added a gcode file to display print time estimates. However, I still strongly recommend that you do your own slicing.

Model files

 plated parts		5 files
	a1-armature.stl	
	a2-hands.stl	
	b-skin.stl	
	c-accessories.stl	
	d-display-base.stl	
 individual parts - armature		30 files

00a01-armature-head.stl



00a02-armature-neck.stl

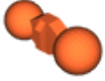

00a03-armature-chest.stl



00a04-armature-abdomen.stl



00a04b-armature-abdomen-for-display-base.stl



00a05-armature-waist.stl



00a06-armature-hips.stl

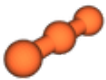

00a07-2x-armature-clavicle.stl



00a08-2x-armature-shoulder.stl

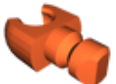

00a09l-armature-upper-arm-left.stl





00a09r-armature-upper-arm-right.stl



00a10l-armature-forearm-left.stl



00a10r-armature-forearm-right.stl

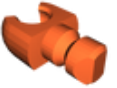

00a11-2x-armature-glute.stl

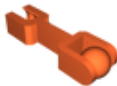

00a12-2x-armature-thigh.stl



00a13-2x-armature-knee.stl



00a14-2x-armature-shin.stl



00a15l-armature-foot-left.stl



00a15r-armature-foot-right.stl

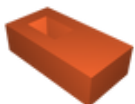

00a16-2x-armature-sole.stl



00a17l-armature-hand-flat-left.stl



00a17r-armature-hand-flat-right.stl



00a18l-armature-hand-neutral-left.stl



00a18r-armature-hand-neutral-right.stl



00a19l-armature-hand-dynamic-left.stl



00a19r-armature-hand-dynamic-right.stl



00a20r-armature-hand-fist-right.stl



00a20l-armature-hand-fist-left.stl



00a21l-armature-hand-grip-left.stl



00a21r-armature-hand-grip-right.stl



individual parts - skin

20 files



00b01-skin-head.stl



00b02-skin-neck.stl



00b03-skin-chest-1.stl



00b04-skin-chest-2.stl



00b05-skin-abdomen.stl



00b05b-skin-abdomen-for-display-base.stl



00b06-skin-waist.stl



00b07-2x-skin-shoulder.stl



00b08l-skin-upper-arm-left.stl



00b08r-skin-upper-arm-right.stl



00b09-2x-skin-forearm.stl



00b10l-5x-skin-hand-left.stl



00b10r-5x-skin-hand-right.stl



00b11-2x-skin-glute.stl

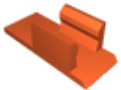

00b12-2x-skin-thigh-1.stl



00b13-2x-skin-thigh-2.stl



00b14-2x-skin-knee.stl



00b15-2x-skin-shin-1.stl



00b16-2x-skin-shin-2.stl



00b17-2x-skin-foot.stl



individual parts - accessories

5 files



00c01-accessory-sword.stl



00c02-accessory-staff.stl



00c03-accessory-flag.stl



00c04-accessory-gun.stl



00c05-accessory-hat.stl



individual parts - display base

4 files



00d01-display-base-plate.stl



00d02-display-base-joint.stl



00d03-2x-display-base-lower-arm.stl



00d04-display-base-upper-arm.stl

Print files



dont_use_this.gcode

PET 0.40 mm 0.15 mm 10.98 hrs 64 g Prusa MK3/S/S+

☐ DON'T USE THIS!! IT'S ONLY HERE TO PROVIDE A TIME ESTIMATE!! SLICE YOUR OWN PARTS!!

Other files

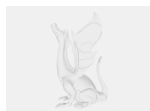

manual.pdf

License

This work is licensed under a
[Creative Commons \(4.0 International License\)](#)



Attribution—Noncommercial—Share Alike

✖ | Sharing without ATTRIBUTION

- ✓ | Remix Culture allowed
- ✗ | Commercial Use
- ✗ | Free Cultural Works
- ✗ | Meets Open Definition