

# 3Dプリントロボット玩具"アトラータメック"組み立てマニュアル

## 3D printed mech toy "Athletamech" assembly manual



2022 By オトカム (Otokam0510)

STL      Version 1.1.0  
Manual Version 1.1.0

## 別途必要なスプリングについて

内径:直径4mm以上

外径:直径6mm以下

自由高さ:18mm前後

密着高さ:8mm以下

28個必要です

## About separately required springs

Inner diameter: 4 mm or more in diameter

Outer diameter: 6mm or less in diameter

Free height: 18mm or so

Solid height: 8mm or less

28 pieces are required

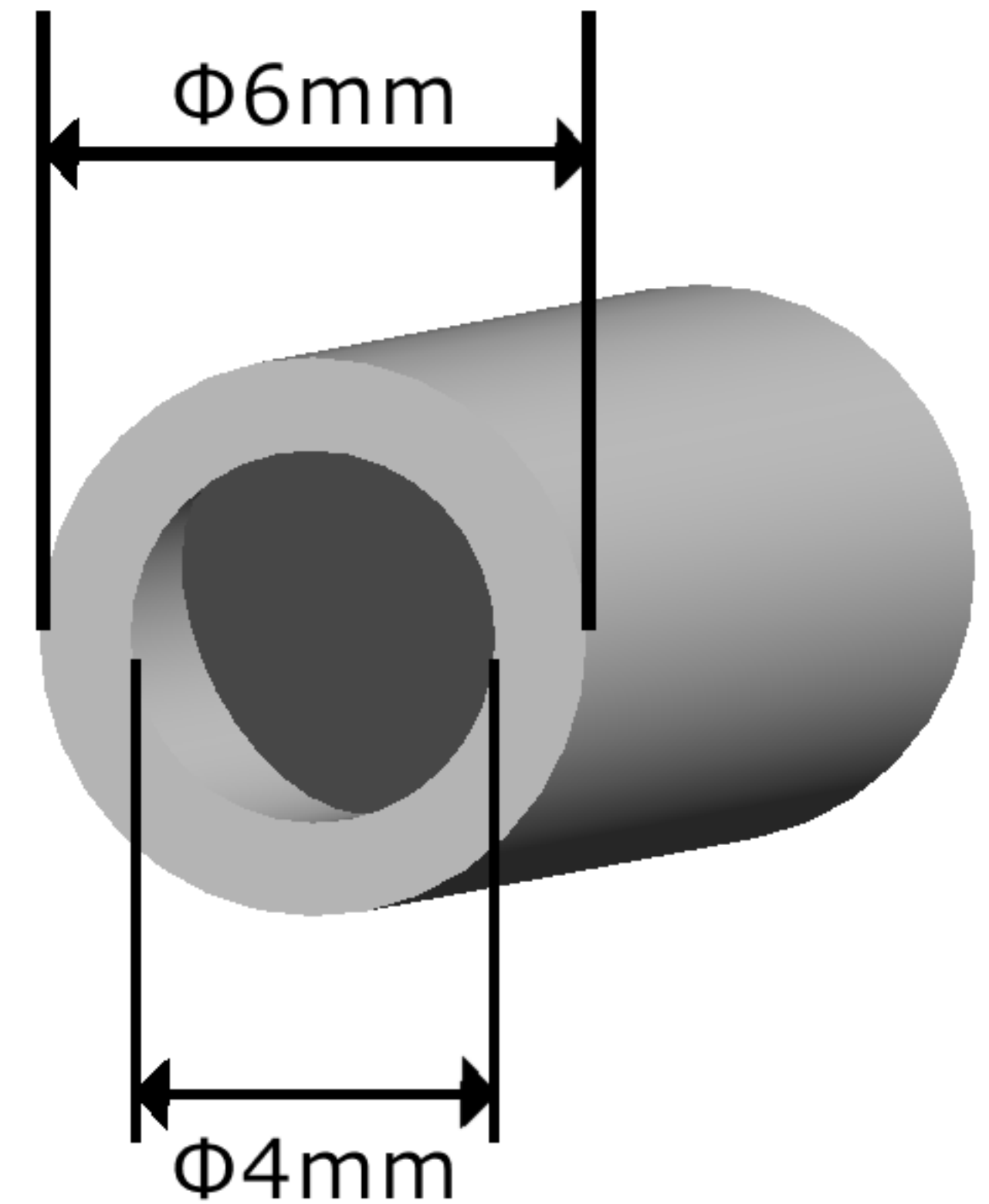



## 主な印刷設定

ノズル口径- 0.4mm

レイヤー高さ- 通常:0.2mm ネジ:0.1mm

外周- 3 ~ 4

インフィル- 通常:8% ネジ:70%

## Printing settings

Nozzle size- 0.4mm

Layer height- Normal:0.2mm Screw:0.1mm

Wall line- 3 ~ 4

Infill- Normal:8% Screw:70%

## サポート材の一例

## Example of support material

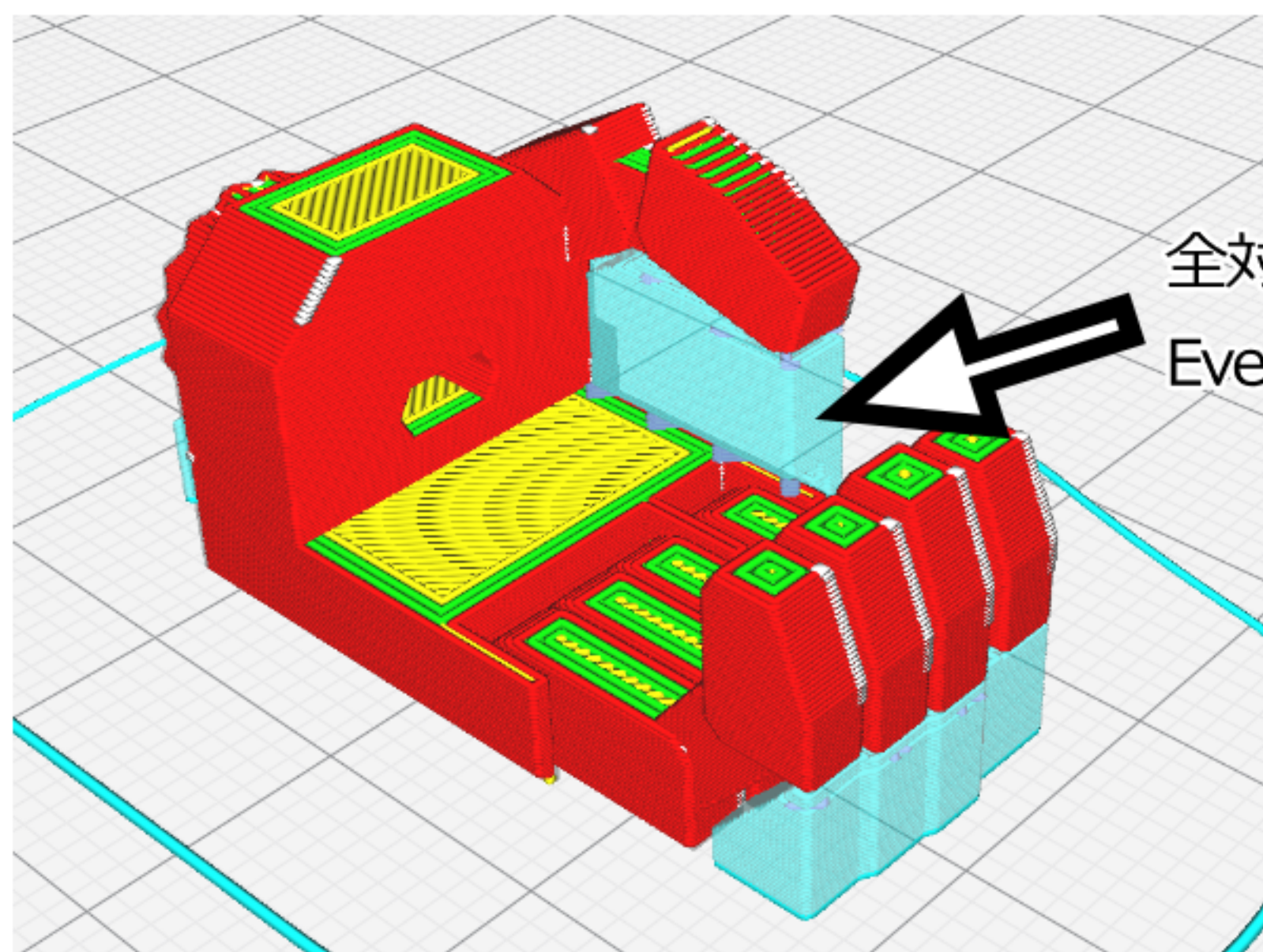

hand\_L.stl

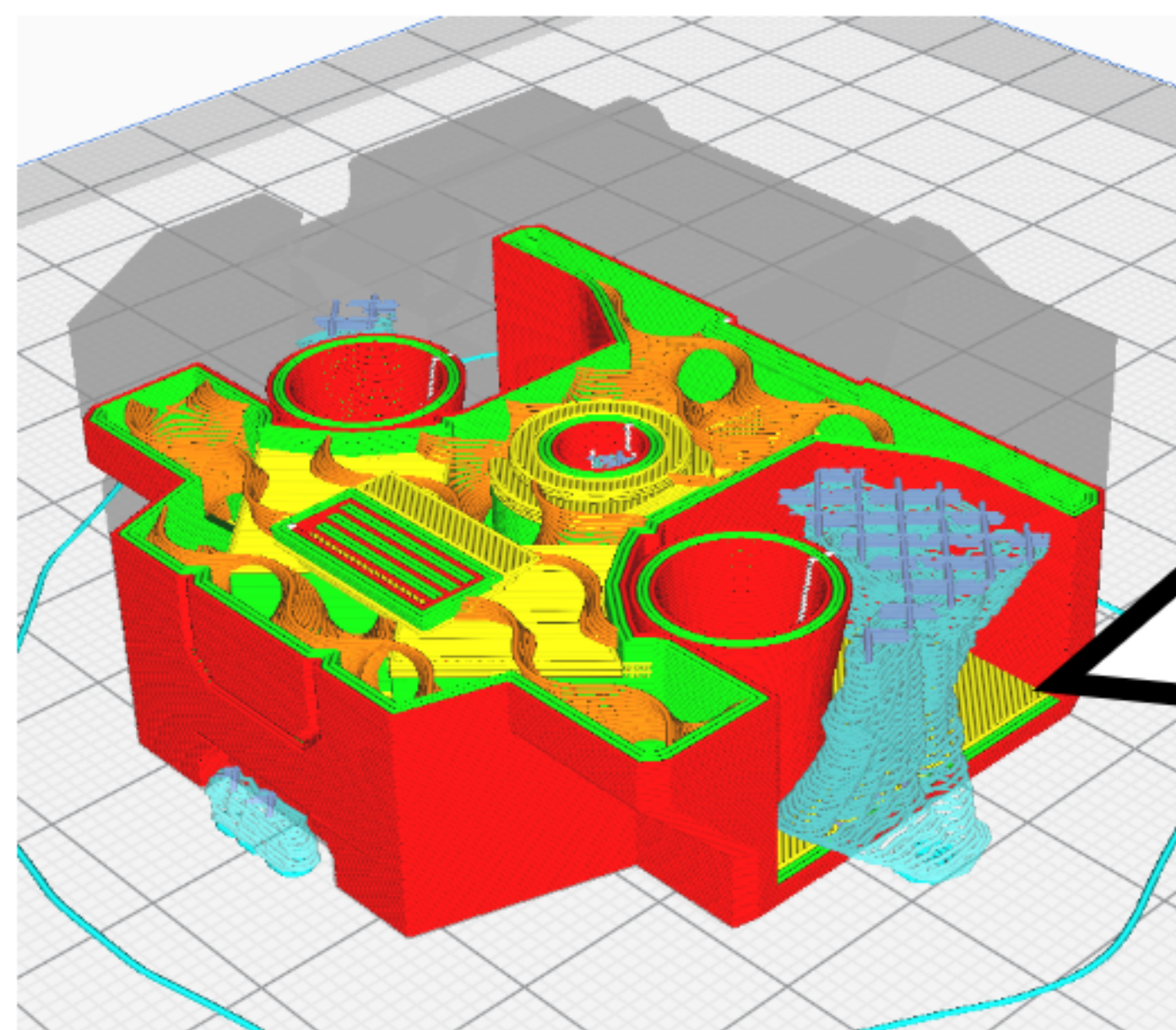

ツリーサポート  
ビルドプレートにタッチ

Tree  
Build Plate Only

upperbody.stl



## ネジの試作 Screw Testing

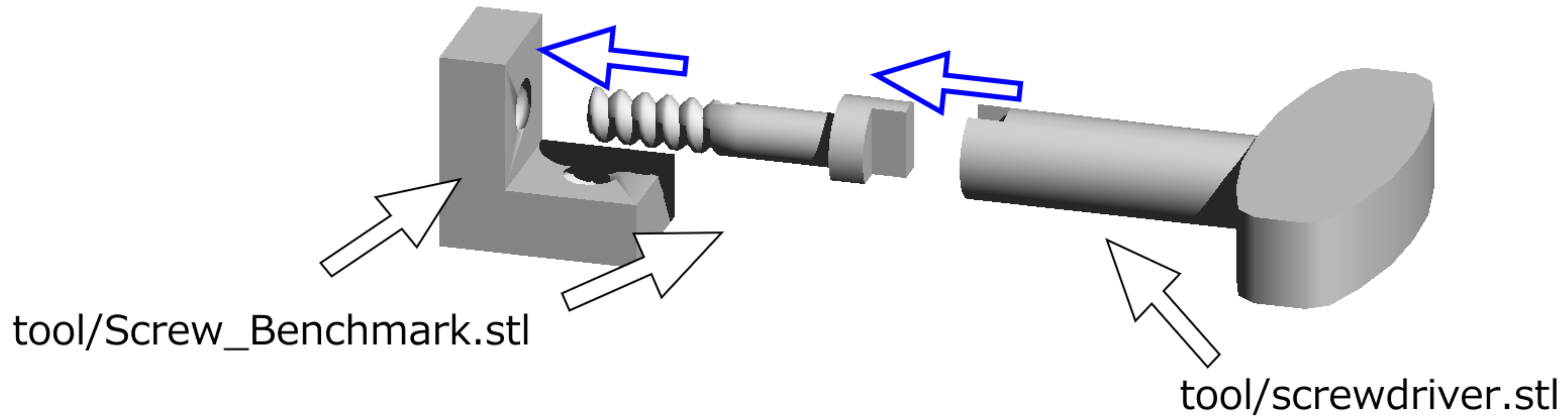

ネジが機能するように調整してください  
Adjust the screws so that they function

頭部の組み立て

Head assembly

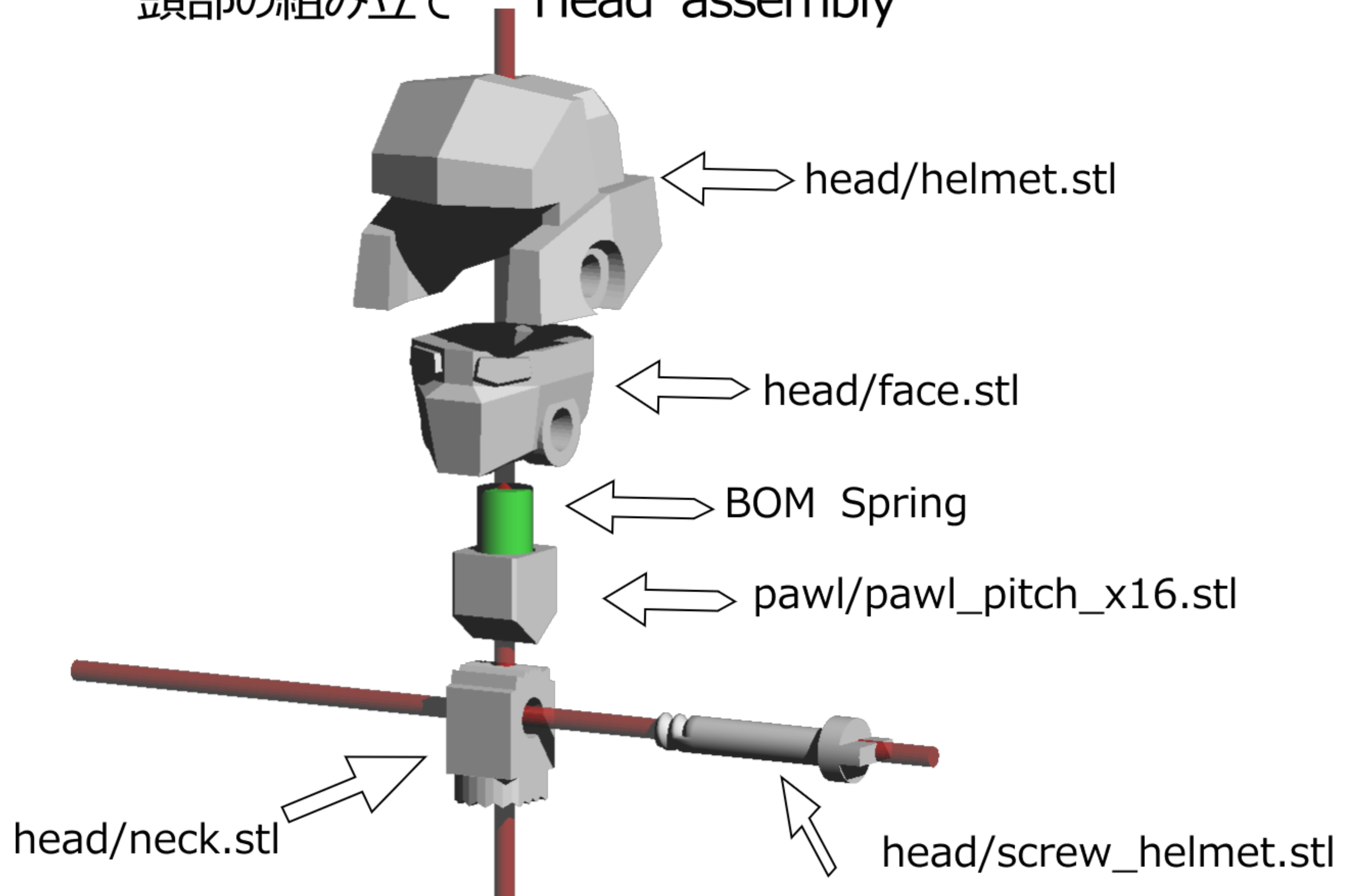

# 胴体の組み立て Torso assembly

## 1

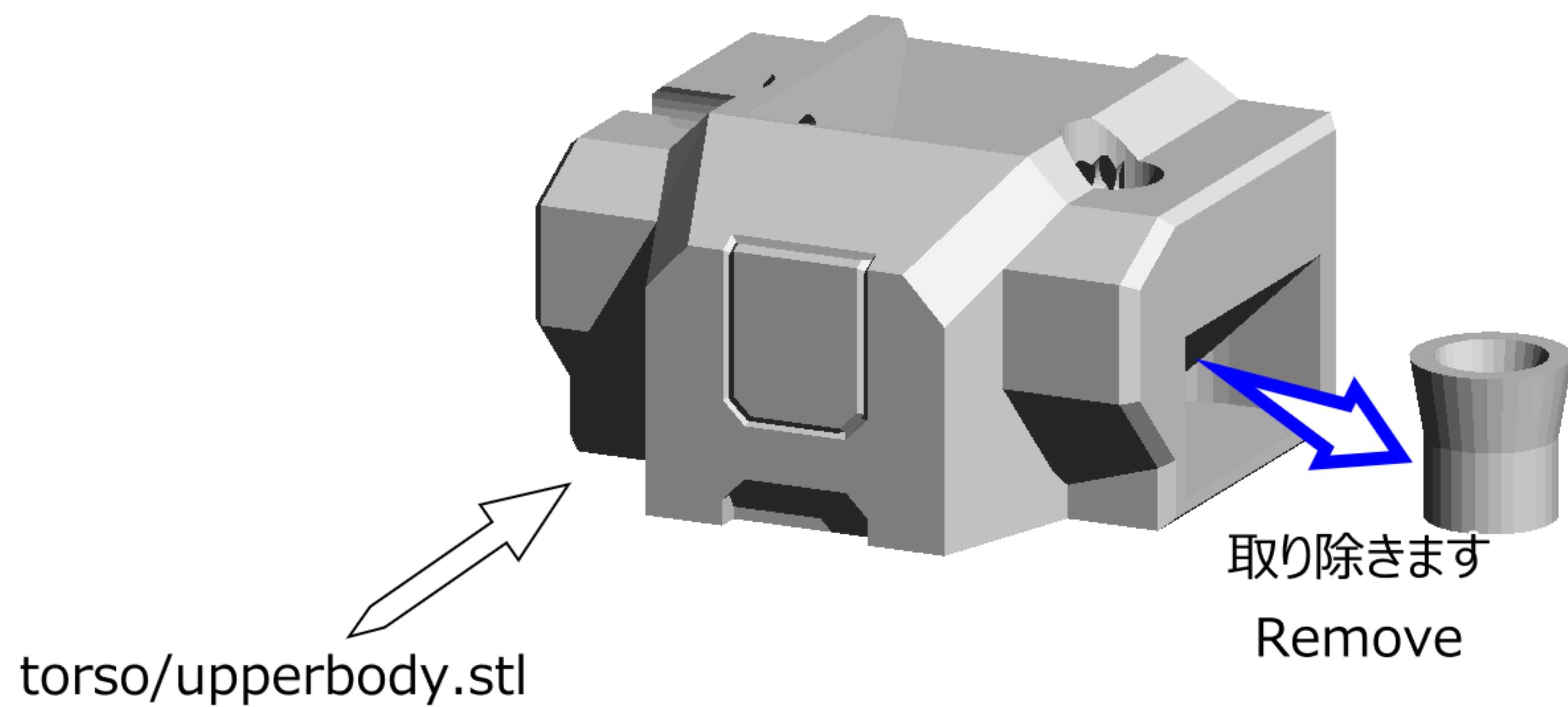

胴体の組み立て

Torso assembly

2



← pawl/pawl\_yaw\_x9.stl

← BOM Spring

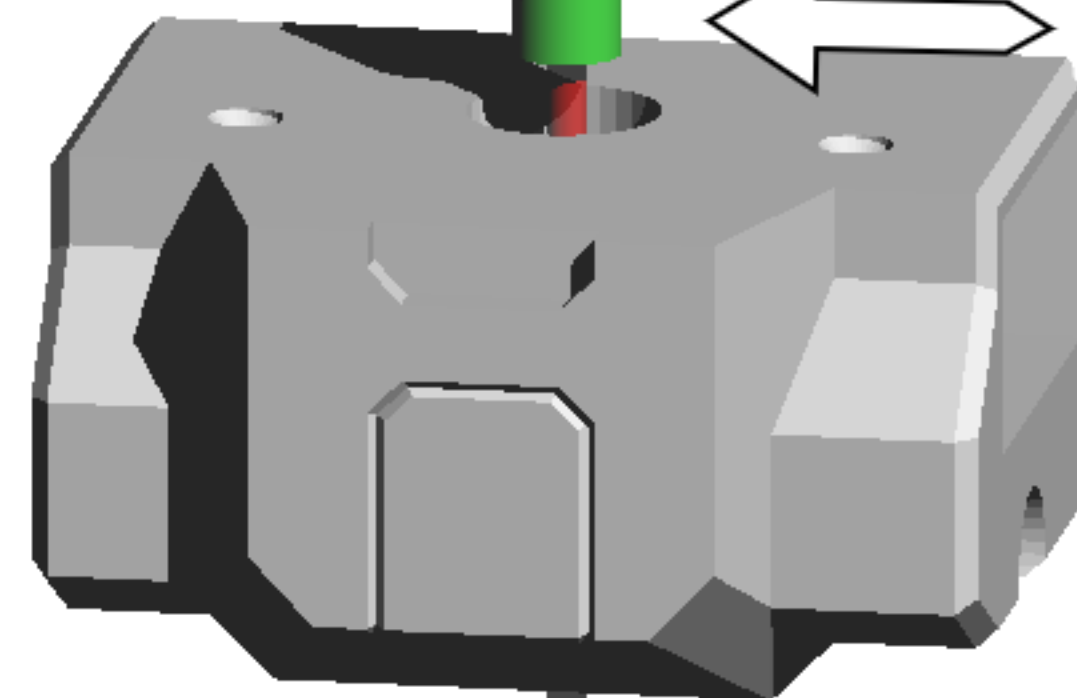

← head/screw\_neck.stl



胴体の組み立て

Torso assembly

3

torso/shoulder\_L.stl

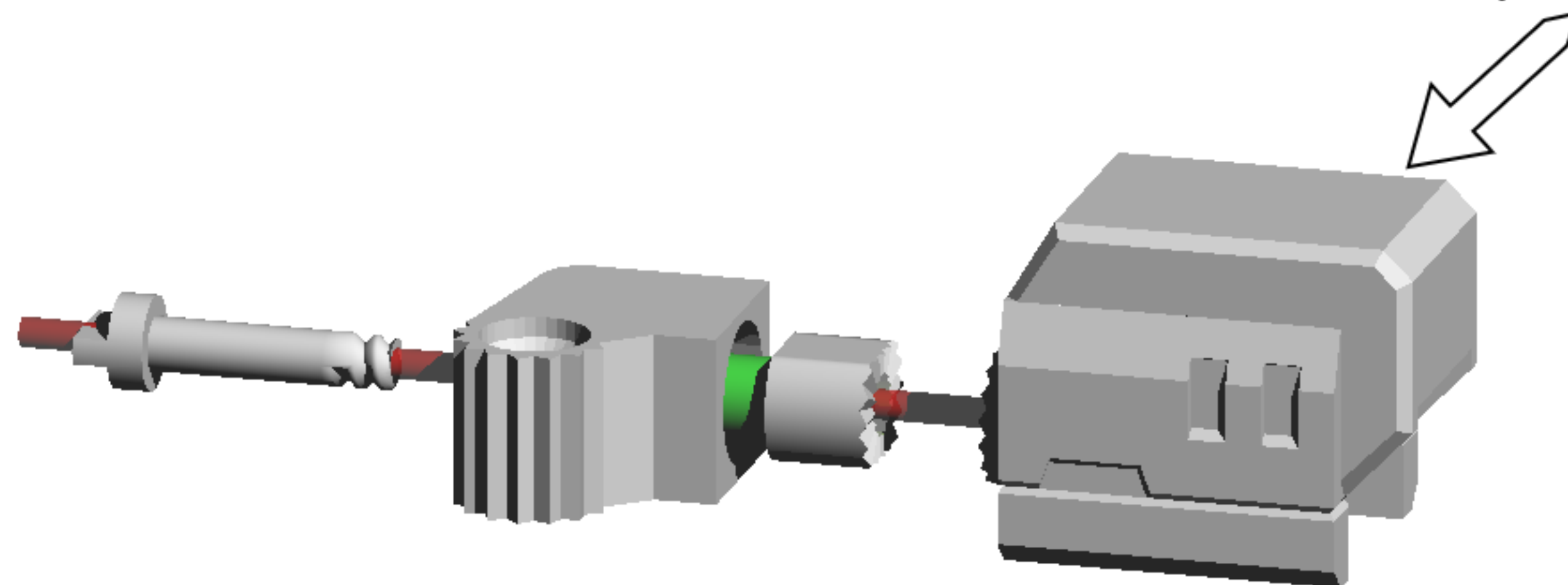

torso/screw\_inner\_shoulder\_x2.stl

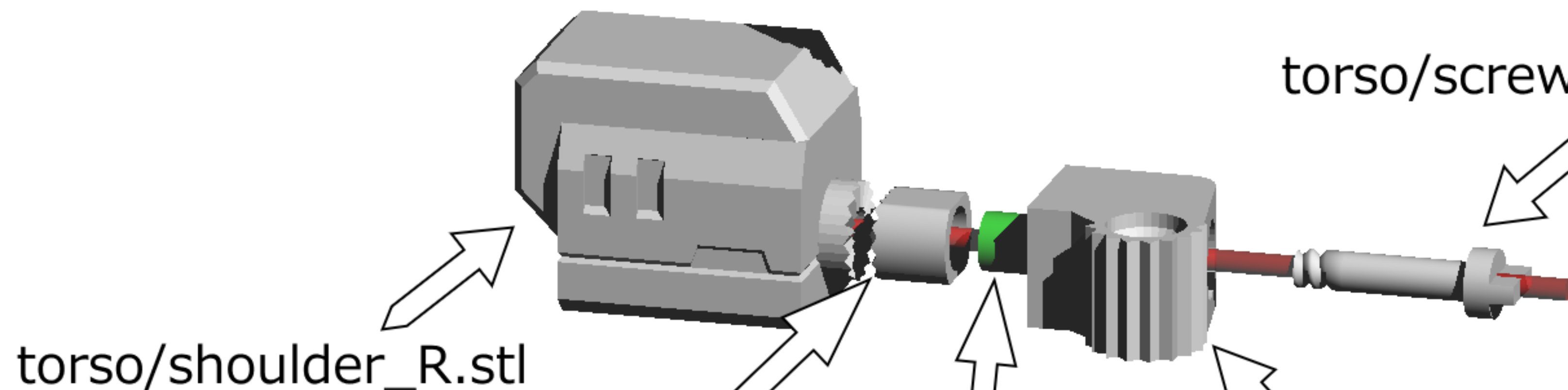

torso/shoulder\_R.stl

pawl/pawl\_yaw\_x9.stl

BOM Spring

torso/inner\_shoulder\_x2.stl



胴体の組み立て

Torso assembly

4

BOM Spring

pawl/pawl\_pitch\_x16.stl

torso/screw\_upperbody\_x2.stl

爪パーツが入らない場合は  
pawl/pawl\_waist\_x2.stlで代用してください。

If pawl does not fit Substitute  
"pawl/pawl\_waist\_x2.stl"

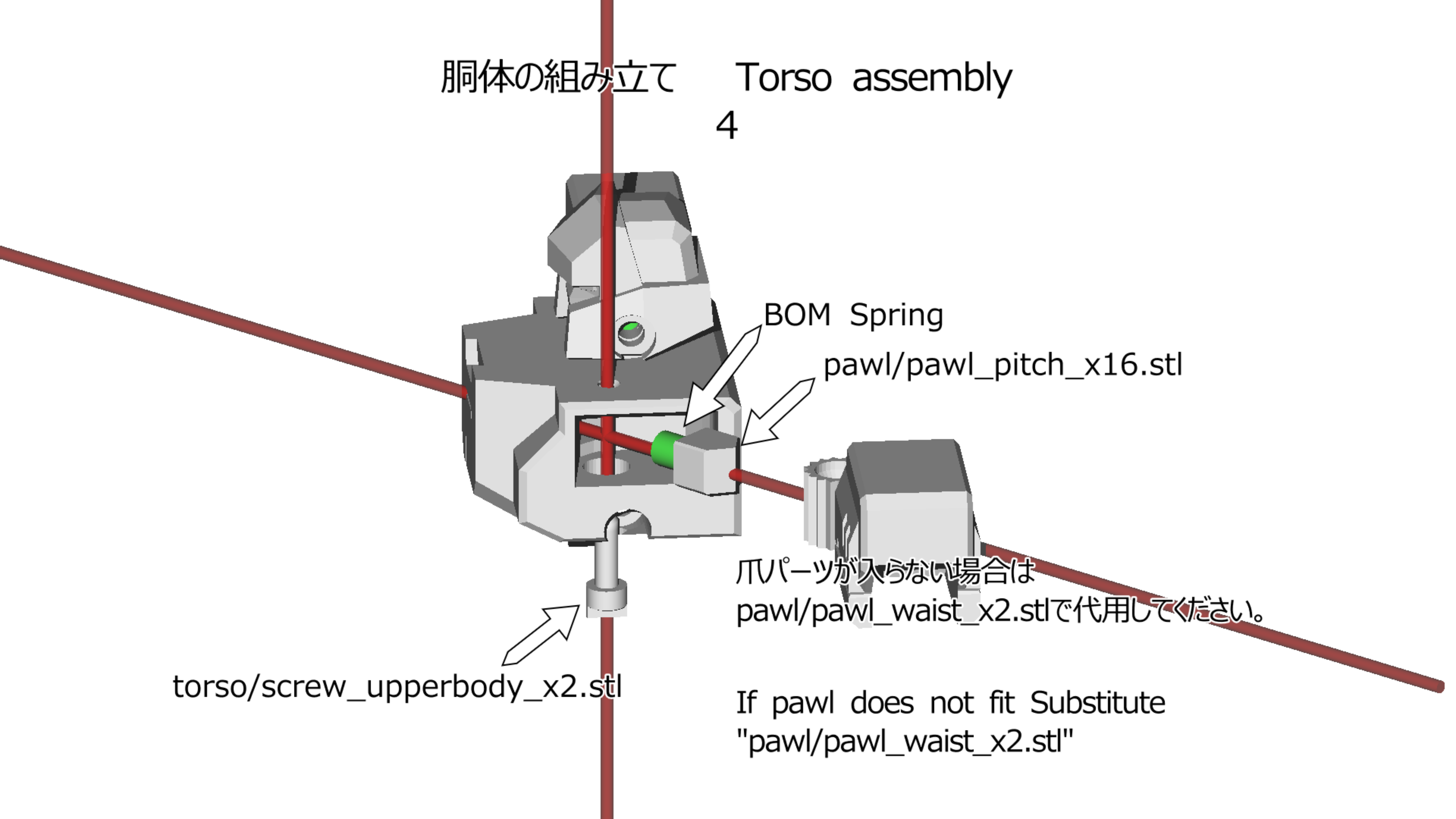

胴体の組み立て

Torso assembly

5

torso/screw\_lowerbody.stl

torso/screw\_backunit.stl

torso/backunit.stl

BOM Spring

pawl/pawl\_pitch\_large.stl

torso/lowerbody.stl

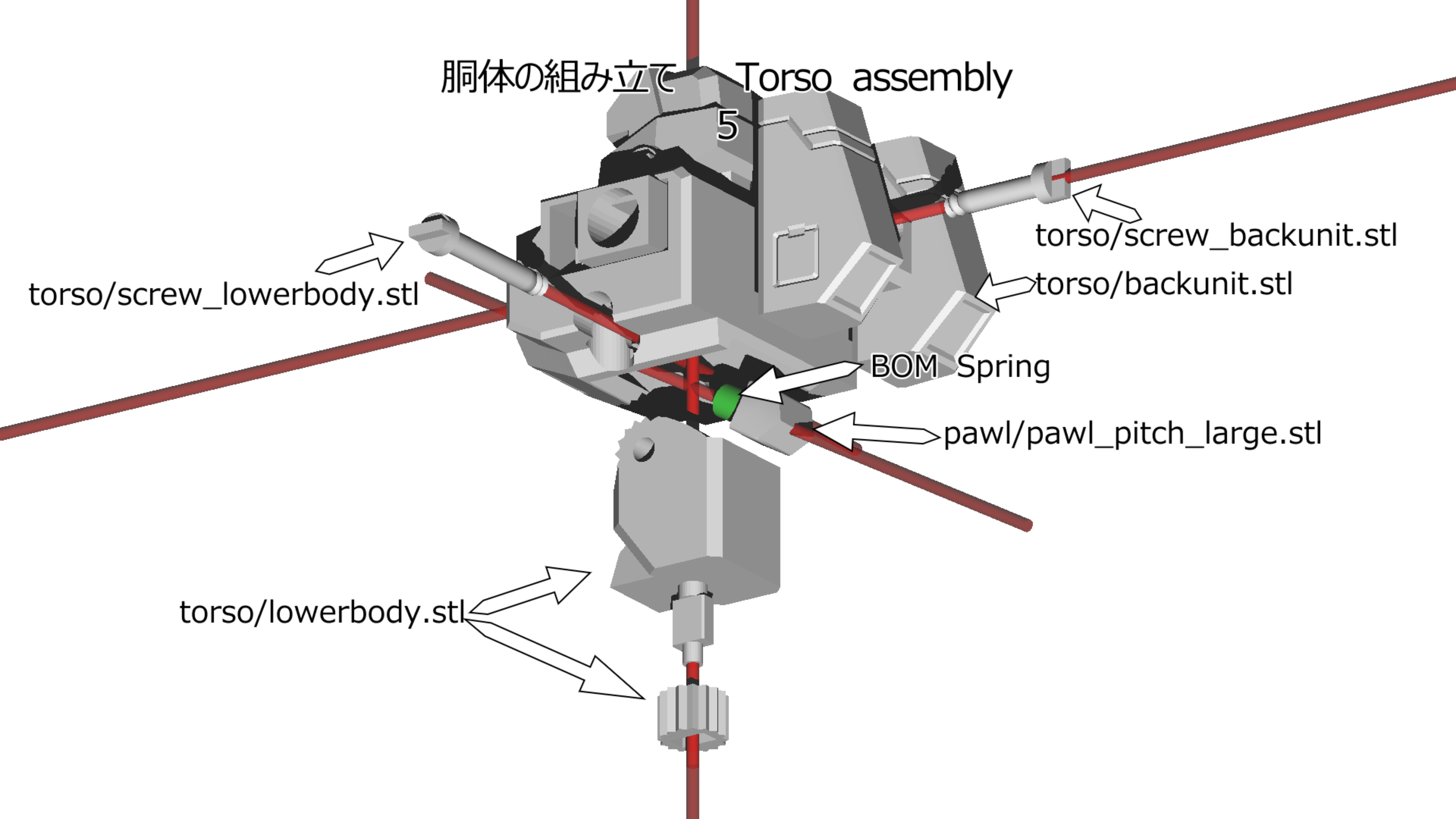

腕の組み立て

Arms assembly  
1

torso/screw\_shoulders\_x2.stl

BOM Spring

pawl/pawl\_pitch\_x16.stl

arms/upperarm\_A\_x2.stl

pawl/pawl\_yaw\_x9.stl

arms/upperarm\_B\_x2.stl

arms/screw\_upperarm\_A\_x2.stl

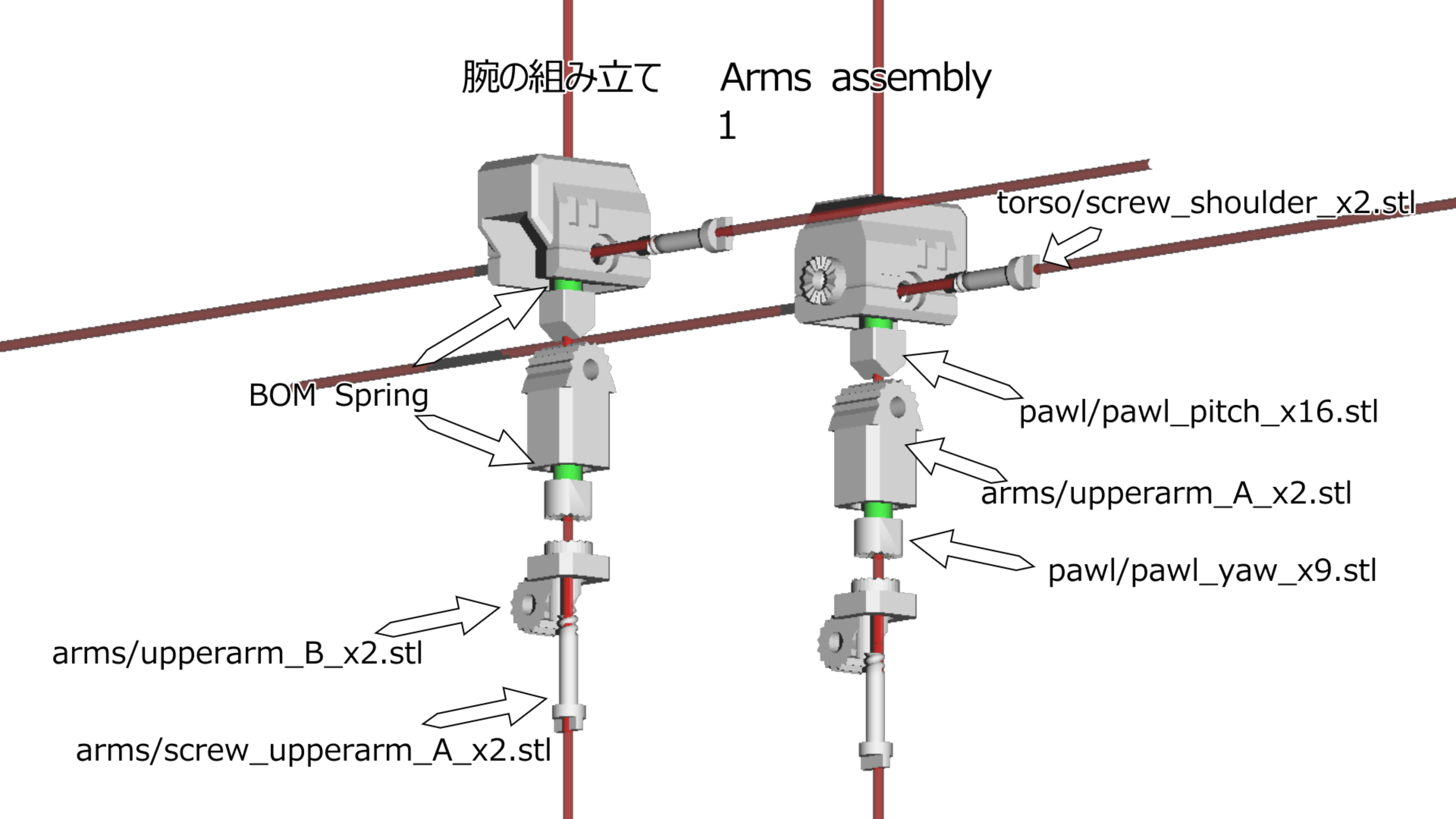



腕の組み立て

Arms assembly  
2

pawl/pawl\_pitch\_x16.stl

arms/lowerarm\_R.stl

arms/screw\_upperarm\_B\_x2.stl

BOM Spring

pawl/pawl\_yaw\_x9.stl

arms/screw\_lowerarm\_x2.stl

arms/lowerarm\_L.stl

arms/hand\_R.stl

arms/hand\_L.stl

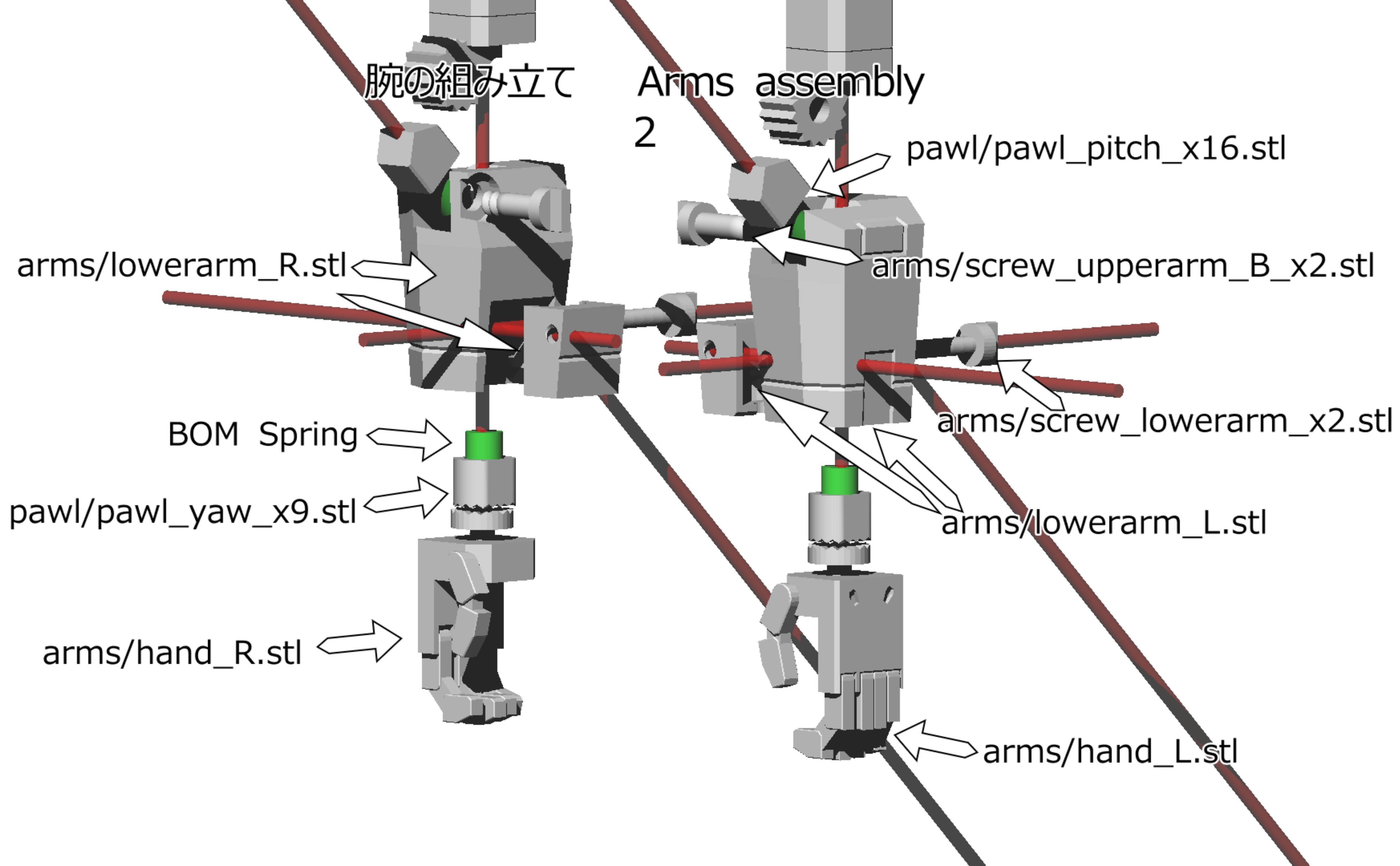



脚の組み立て

Legs assembly

1

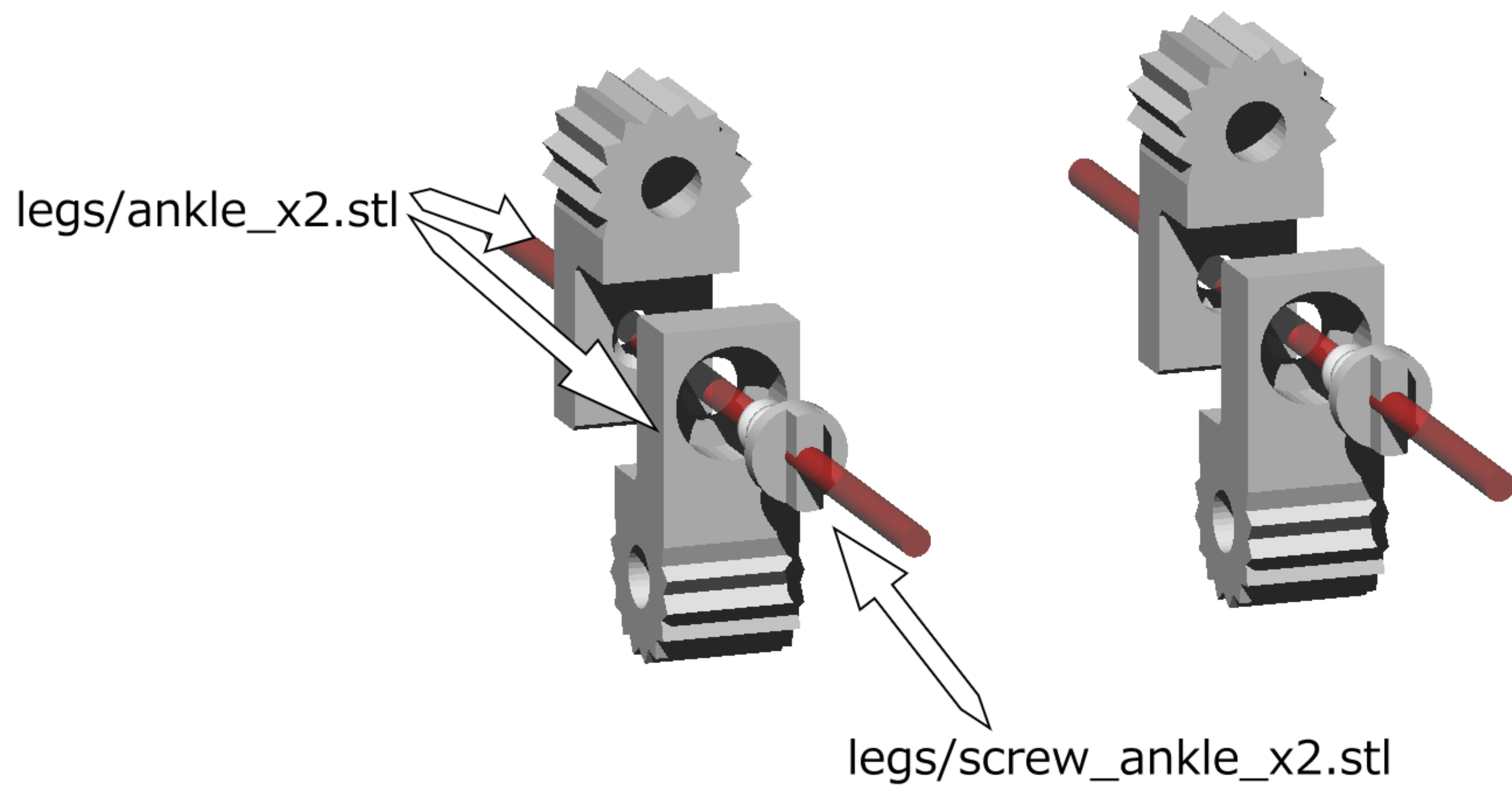

脚の組み立て

Legs assembly  
2

pawl/pawl\_yaw\_x9.stl  
BOM Spring

legs/upperleg\_A\_x2.stl

legs/upperleg\_B\_x2.stl

legs/screw\_upperleg\_A\_x2.stl

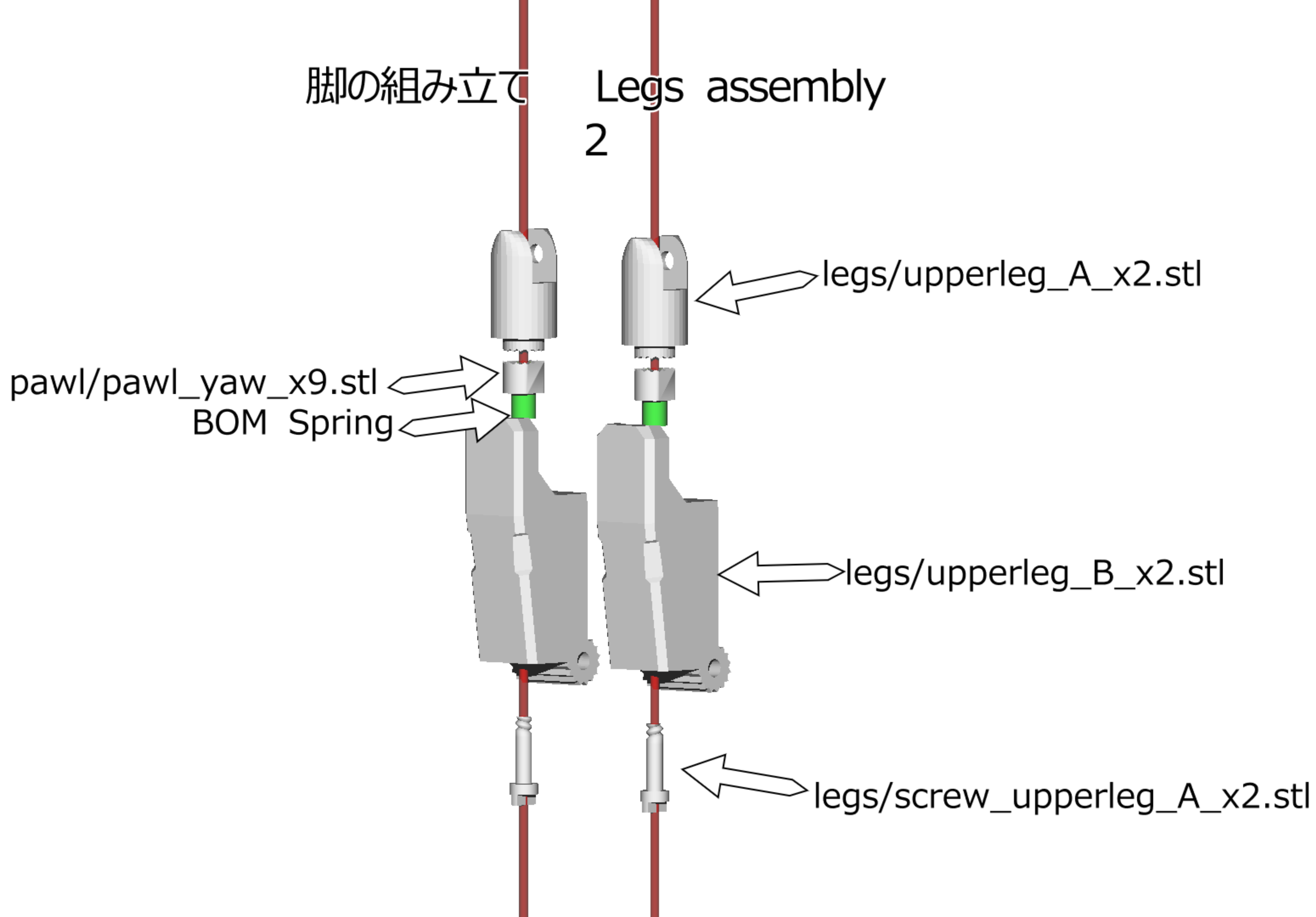

脚の組み立て

Legs assembly

3

legs/screw\_lowerleg\_x4.stl

legs/lowerleg\_R.stl

legs/lowerleg\_L.stl

BOM Spring

pawl/pawl\_pitch\_x16.stl

legs/toe\_L.stl

legs/screw\_toe\_x2.stl

legs/toe\_R.stl

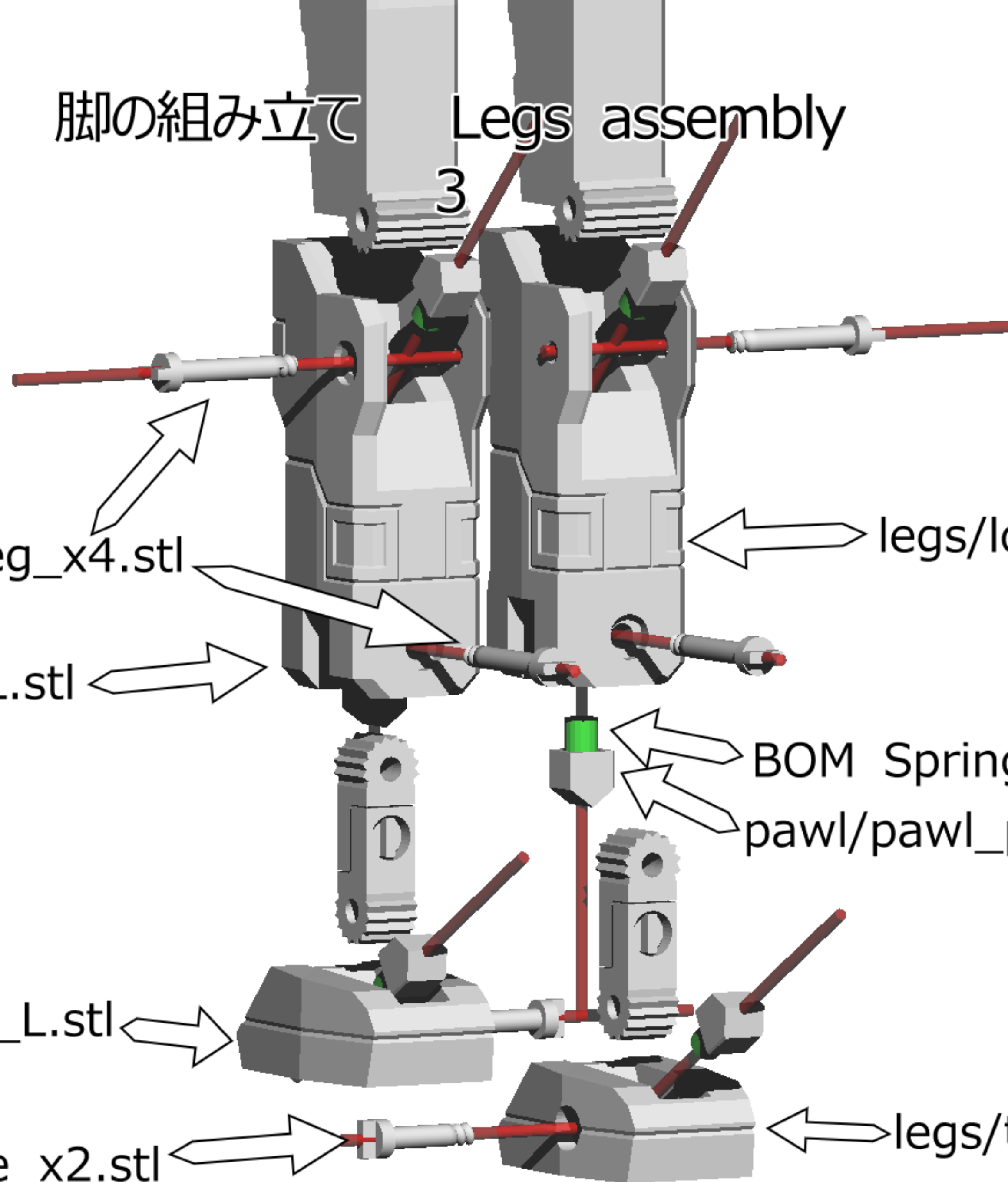

# 腰の組み立て Waist assembly

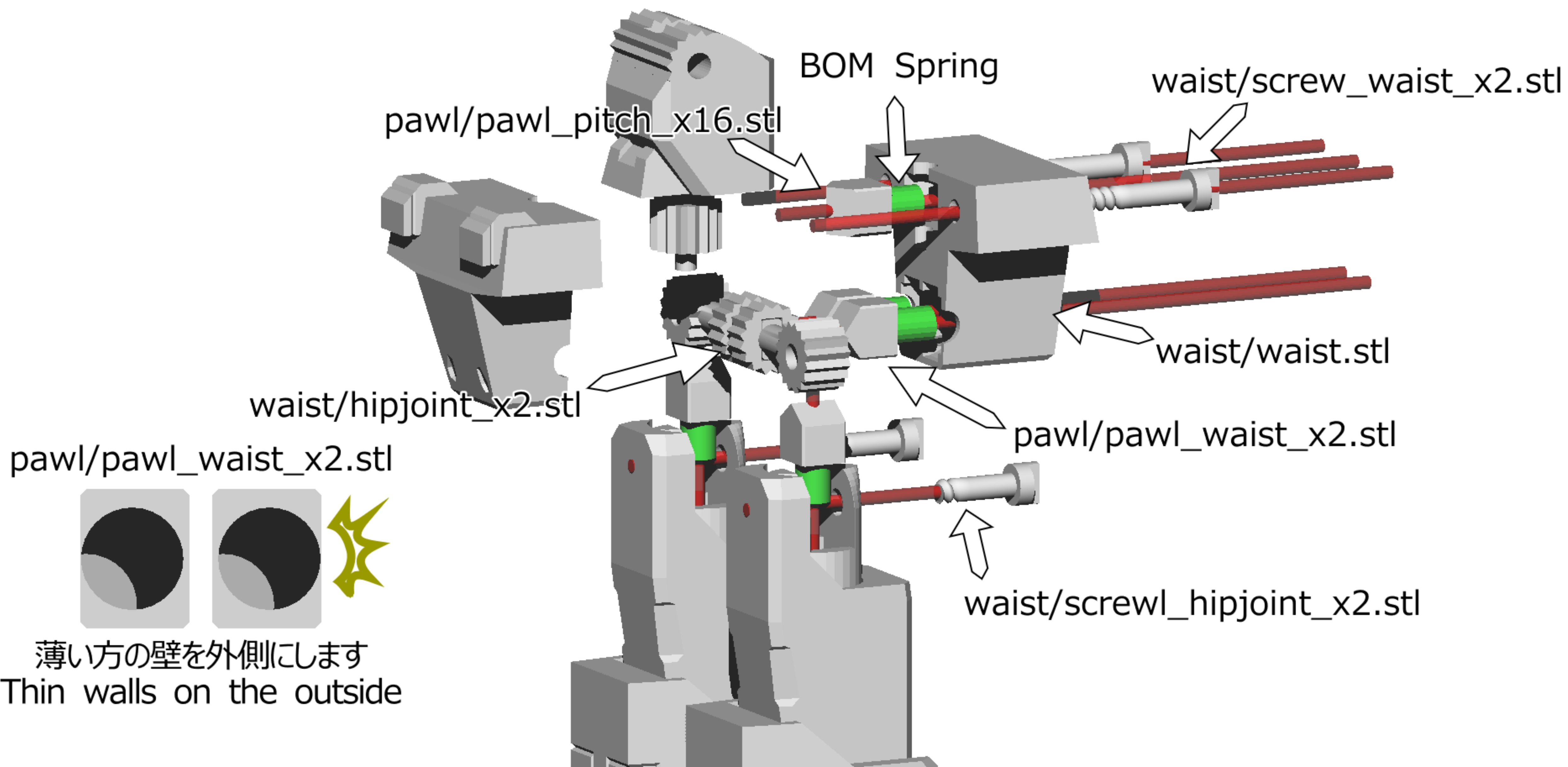



腰の組み立て

Waist assembly

2

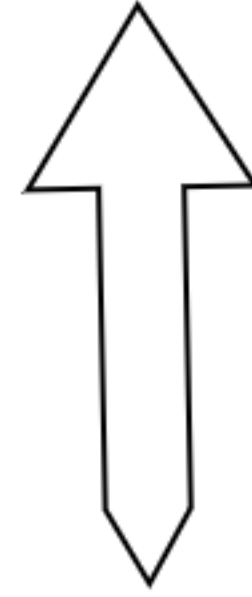
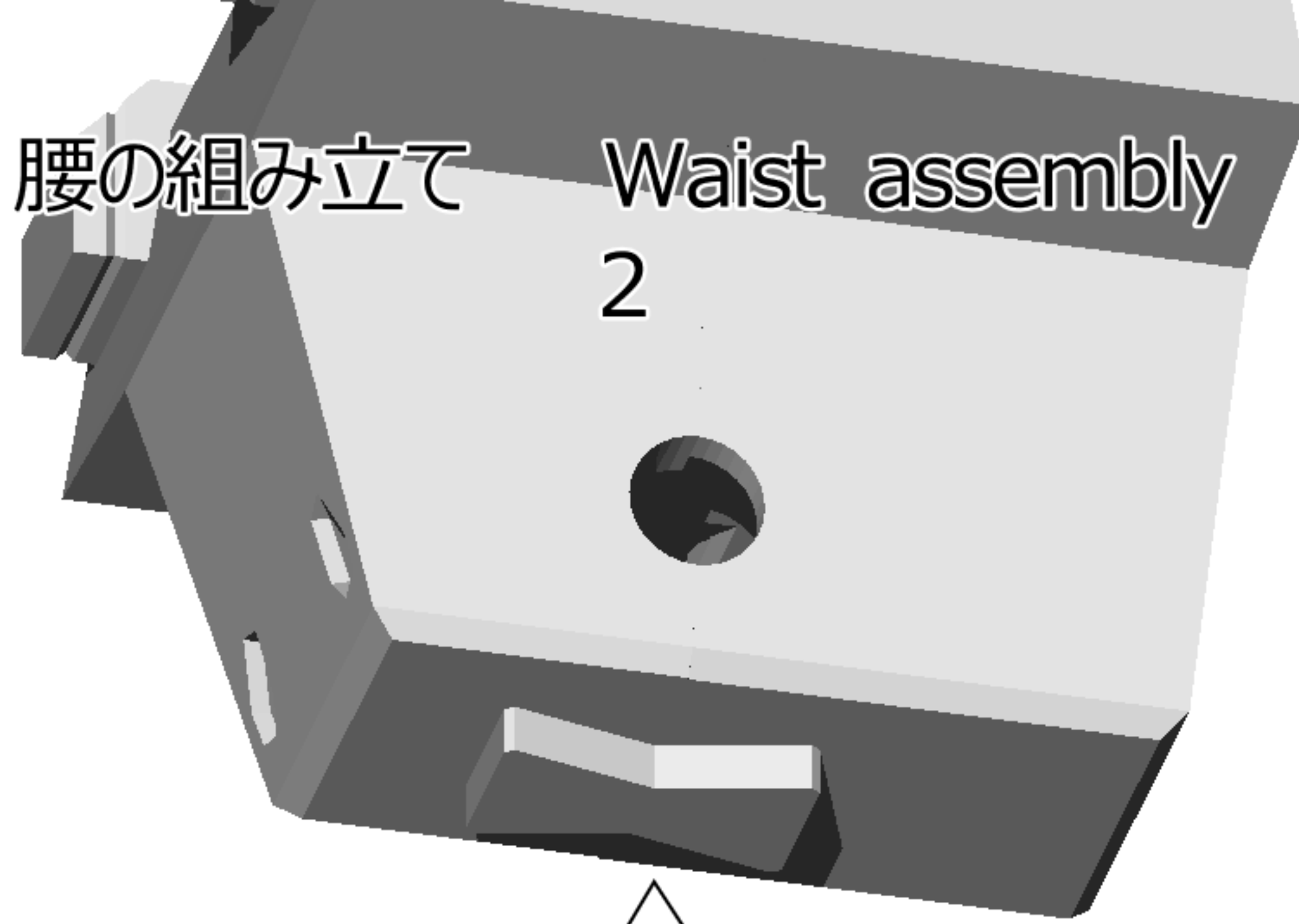

waist/waist\_closure.stl

## 武器の装備      Equipped with weapons

