

## Anycubic "SPINE" Cable Chain (BETA) for Kobra 2 Series printers , Kobra 2 Max , Kobra 2 Pro , Kobra 2 Plus , Kobra 2 Neo , Kobra 2



FreshPrintsofBelair

[VIEW IN BROWSER](#)

updated 23. 1. 2024 | published 23. 1. 2024

## Summary

This solves the problem of the poor cable management on the Kobra 2 Series printers.

[3D Printers](#) > [Anycubic Parts & Upgrades](#)

Tags: [cable](#) [anycubic](#) [cablemanagement](#) [cableholder](#) [kobra](#) [kobra2](#) [kobra2pro](#) [kobra2max](#) [kobra2plus](#) [kobra2neo](#)

The Spine chain was made popular by @rogerquin\_304616 when he designed it for the SOVOL SV06 . This is my version for the Anycubic Kobra 2 Series printers. This is my original work and drawings all inspiration for this design goes to @rogerquin\_304616.

This solves the problem of the poor cable management on the Kobra 2 Series printers.

**This is BETA Pre- Release (DO NOT REMIX)** I have a busy schedule this is the easiest way I can develop and manage my day-to-day life. Thanks for understanding.

**To Install Start at mounts and work your way back.**

### **Print Instructions**

PLA or equivalent

100 % infill on all links

You will need Organic Tree supports on : Tie Wrap Replacement and Kobra 2 Max Frame mount

### **Number of Links needed:**

(Beta Numbers subject to change this get you in the ballpark)

#### **Kobra 2 Max:**

**Extruder End Mount : 1**

**Sensor to Extruder Link: 33**

**Space Filler : 1**

**Tie Wrap Replacement : 1**

**Tie-In at Filament Sensor Bracket : In Development**

**Hanging Cable Frame to Sensor: 37**

**Kobra 2 Max Frame Mount: 1**

**Kobra 2 Pro : Extruder End Mount : 1**

**Sensor to Extruder Link: 21**

**Space Filler : 1**

**Tie Wrap Replacement : 1**

**Tie-In at Filament Sensor Bracket: In Development**

**Hanging Cable Frame to Sensor 30**

**Kobra 2 Pro Frame Mount: In Development ( Really don't need one)**

**\*\*If you have a problem or find defects, Something I missed please report it to me. This is Beta so don't leave rating. Unless you already love it. :) Feedback and thoughts all welcome message me in my inbox on this site or in Facebook group.**

### **Release Notes to any changes I make.**

- All cable links are completed and functional.
- End mount to Extruder is completed for all Kobra 2 Series Printers.
- Kobra 2 Max Frame Mount is Completed (To use this mount you must reroute your cable under the printer). You can still use Spine without End mount if don't wish to do this.
- Still working on documentation.
- Still developing bracket for Runout Sensor Mount Area to tie X-Gantry Cable Together.
- Still developing brackets for all Kobra 2 Series printers

1/19/2024

**Sensor to Extruder Link** Update to 1.1 Now has no teeth on clip. I think this is a better design allows more flexibility and movement.

1/22/2024

**Extruder End Mount v1.1:** Opened up ball end more so won't be as tight.

**Hanging Cable Frame to Sensor Link v1.1:** reinforced clip and opened up socket on female side of link.

**Kobra 2 Max Frame Mount v1.1:** Open up holes and cosmetic improvements

## **Model files**

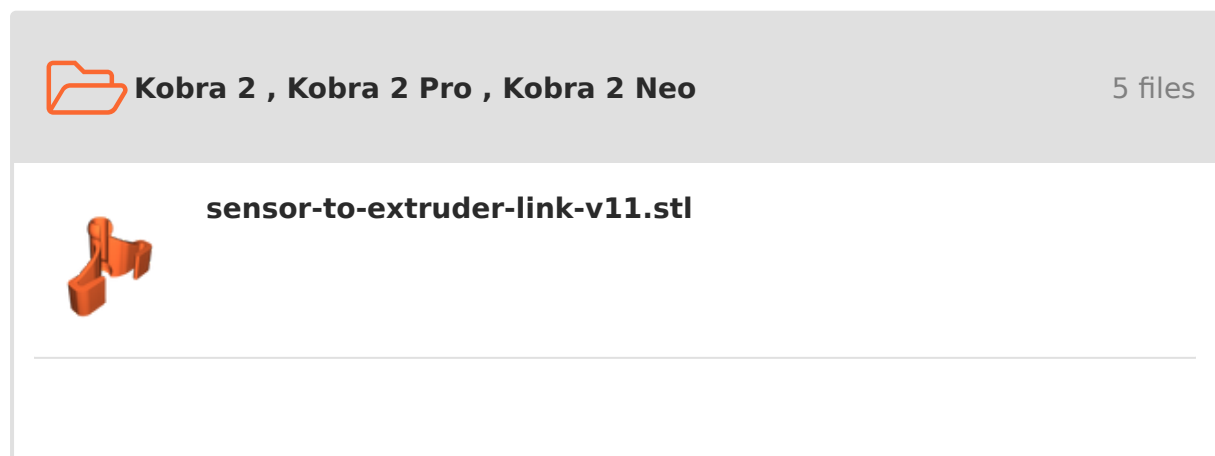



### hanging-cable-frame-to-sensor-link-v11.stl

☐ This link goes from Frame to Runout Sensor



### extruder-end-mount-v11.stl

☐ Goes on Extruder

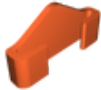

### space-filler-v1.stl

☐ Goes Between Tie Wrap Replacement Link and Sensor to Extruder Link v1

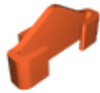

### tie-wrap-replacement-v1.stl

☐ Goes on Filament Sensor mount replace tie wrap on cable.



## Kobra 2 Max

6 files



### sensor-to-extruder-link-v11.stl



### hanging-cable-frame-to-sensor-link-v11.stl

☐ This link goes from Frame to Runout Sensor



### extruder-end-mount-v11.stl

☐ Goes on Extruder



### space-filler-v1.stl

☐ Goes Between Tie Wrap Replacement Link and Sensor to Extruder Link v1

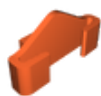

### tie-wrap-replacement-link-v1.stl

☐ Goes on Filament Sensor mount replace tie wrap on cable.



### kobra-2-max-frame-mount-v11.stl

☐ M5 Bolt / Goes where the spool holder was mounted from the factory. Use the existing bolt holes

## License

This work is licensed under a  
[Creative Commons \(4.0 International License\)](https://creativecommons.org/licenses/by-nc-nd/4.0/)



**Attribution—Noncommercial—No Derivatives**

- ✗ | Sharing without ATTRIBUTION
- ✗ | Remix Culture allowed
- ✗ | Commercial Use
- ✗ | Free Cultural Works
- ✗ | Meets Open Definition