



## Poseable Articulated Robot Hand (3MF/sorted/ scaled)



Angus B. Clark

[VIEW IN BROWSER](#)

updated 7. 7. 2024 | published 7. 7. 2024

### Summary

Remix of the popular poseable robot hand, with 3MF files sorted into colours. Also available as a scaled model.



72.20 hrs



7 pcs



0.20 mm



0.40 mm



PLA



644 g



Prusa  
MK3/S/S+

[Art & Design](#) > [Other Art & Designs](#)

Tags: [robot](#) [hand](#) [human](#) [articulated](#) [poseable](#) [jointed](#)  
[robothand](#)

Decided to add the 3MF for the popular robot hand model by Make-a-print to make printing easier in different colours. Files have been separated according to the original design colours.

Two folders of files are available, one for the full size hand, and another for a 62% scaled version.

If not printing the mount, you can save 17/6 hours (full/scaled version).

# This remix is based on



## Poseable articulated Robot Hand (left) jointed together (PLA)

by Make-A-Print

## Model files



### 3MF Files (full size)

4 files

#### part-1-optional-different-colour-print.3mf



#### part-2.3mf

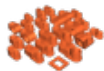

#### part-3.3mf



#### part-4-optional-mount.3mf



### 3MF Files (Scaled 62%)

3 files

#### part-1-62-optional-different-colour-print.3mf





**part-2-62.3mf**



**part-3-62-optional-mount.3mf**

## Print files



**GCode Files (MK3S, Full size, total 54 hours)**

4 files

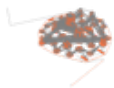

**part-1-optional-different-colour-print.gcode**

⚙️ PLA ⚙️ 0.40 mm ⚙️ 0.20 mm ⌚ 6.43 hrs ⚖️ 49 g 🖨️ Prusa MK3/S/S+

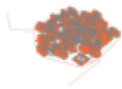

**part-2.gcode**

⚙️ PLA ⚙️ 0.40 mm ⚙️ 0.20 mm ⌚ 14.26 hrs ⚖️ 124 g 🖨️ Prusa MK3/S/S+

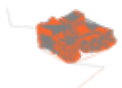

**part-3.gcode**

⚙️ PLA ⚙️ 0.40 mm ⚙️ 0.20 mm ⌚ 16.80 hrs ⚖️ 163 g 🖨️ Prusa MK3/S/S+

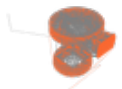

**part-4-optional-mount.gcode**

⚙️ PLA ⚙️ 0.40 mm ⚙️ 0.20 mm ⌚ 16.23 hrs ⚖️ 159 g 🖨️ Prusa MK3/S/S+



**GCode Files (MK3S, Scaled 62%, total 19 hours)**

3 files

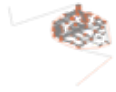

### part-1-62-optional-different-colour-print.gcode

PLA 0.40 mm 0.20 mm 1.81 hrs 13 g Prusa MK3/S/S+

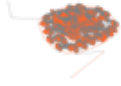

### part-2-62.gcode

PLA 0.40 mm 0.20 mm 10.83 hrs 86 g Prusa MK3/S/S+

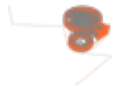

### part-3-62-optional-mount.gcode

PLA 0.40 mm 0.20 mm 5.84 hrs 50 g Prusa MK3/S/S+

## License ©



This work is licensed under a  
[Creative Commons \(4.0 International License\)](#)

**Attribution-NonCommercial**

- ✗ | Sharing without ATTRIBUTION
- ✓ | Remix Culture allowed
- ✗ | Commercial Use
- ✗ | Free Cultural Works
- ✗ | Meets Open Definition